



Real Estate Development and Facilities (RED+F)
Housing Services One Park Avenue, New York, NY 10016 housing@nyulangone.org

INFORMATION FOR STUDENTS: Jan and Marica Vilcek Hall (334 East 26th St.)

Information is subject to change.

Each suite has two or four bedrooms, seasonal heat and air conditioning, window blinds, a common area, bathroom and kitchen. (Four-bedroom suites each have two bathrooms.) Suites are single-sex, with a few voluntary exceptions. There are a limited number of studio apartments, and housing for larger households. Each apartment kitchen is equipped with a refrigerator, stove (cooker), oven, and sink. Microwave ovens are not provided. Personal refrigerators of any size may not be brought into the building. Cooking appliances may not be used in bedrooms.

Bedrooms can be furnished with a bed, dresser, desk, and chair, at no charge, subject to availability. Beds are twin size. Furniture requests are included in the online housing acceptance process.

There are no storage facilities in the building. There is 24-hour staffing in the lobby. The building has a laundry room, a lounge, music room, study spaces, and fitness facilities. Building residents must carry their NYU Langone identification badges.

Tenants using moving companies are required to provide certificates of insurance (COI), emailed in advance of moving in, to Property.Management@nyulangone.org

Pets are not permitted. Smoking, including e-cigarettes, is not permitted in or around NYU Langone facilities, including its residences.

Your mailing address: Your Name, 334 East 26th Street, Suite and bedroom #, New York, NY 10010

Please do not send packages, furniture or other deliveries in advance of your arrival because these cannot be accepted or stored. Please note that mail and package services are provided only to tenants and family members authorized by NYU Langone Housing, as reflected on the building roster. Be prepared to show ID as requested.

Packages are distributed via the package room located on the 2nd floor. The package room hours are Monday-Friday (except holidays) 8:00 am to 9:00 pm, and Saturdays, 10:00 am to 6:00 pm (closed for lunch on Saturdays from 1:00 pm to 2:00 pm). You must provide your email address to them. Questions about packages can be directed to: vilcekpackages@supremesystems.com

The building superintendent is Angel Ortega Angel.Ortega@nyulangone.org (212) 263-2396
Lobby Security desk telephone number (646) 501-4490

Property Management staff oversees the repairs, furniture, building systems, and other maintenance activities in your building. If you need help that your superintendent can't provide, please contact Property.Management@nyulangone.org

Utilities: Electricity, WiFi, and NYU Campus Cable television service are included. Campus Cable has a TV Center www.nyu.edu/tv.media/tv.center To access the WiFi network, you will need to look for LMC Mobile Residential and log in with your medical center Kerberos ID (email user name) and password. For assistance with WiFi or other connectivity issues, please contact the IT help desk, (212) 263 6868, or #helpdesk@nyulangone.org Housing Services cannot assist with email or connectivity issues.

Unloading a car in front of Vilcek Hall can be challenging due to traffic flow and New York City regulations. We suggest that someone stay with the car at all times.

Nearby Public Parking Facilities

Icon West Plaza:	301 East 26 th St, across the street from Vilcek Hall
Imperial Parking:	300 East 25 th St, left turn from First Ave.
Icon Kips Bay Parking:	240 East 27 th St, left turn from First Ave.

Floor plans may not reflect variations in individual suites/apartments.

Sample 2 Person Shared Unit Floor Plan

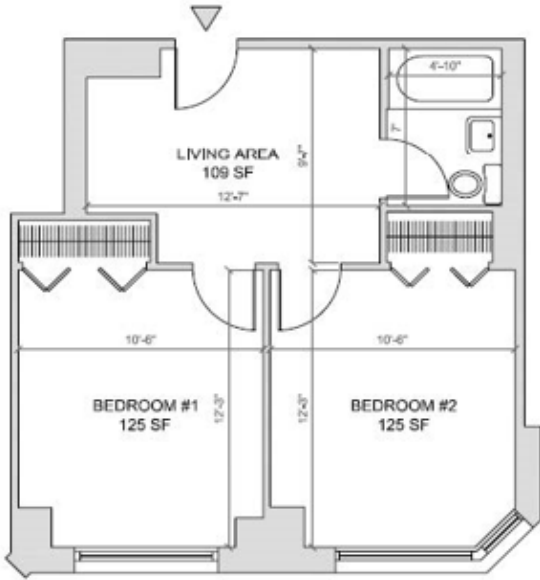

Sample standard studio



UNIT K STUDIO, 1 BATH 286 SF
2ND TO 25TH FLOOR

334 EAST 26TH STREET
NEW YORK, NY 10010



Note: All dimensions are approximate. Always refer to actual unit models.

Sample larger studio



UNIT E STUDIO, 1 BATH 306 SF
2ND TO 25TH FLOOR

334 EAST 26TH STREET
NEW YORK, NY 10010



Note: All dimensions are approximate. Always refer to actual unit models.